



### APPLICATION:

Observation and illumination of the liquid level inside closed vessels (boilers, tanks, silos, etc.).

These sightglasses are angular flange sockets for welding in or on, each completed with a firmly screwed sightglass plate inserted between the seals.

### INSTALLATION NOTE:

After the base frame has been welded in, check whether the sealing surfaces have warped! If necessary, rework must be performed! Please also observe the specified torques for the screw connection! The operating pressure does not apply to the base frame, which must be checked together with the pressure device according to AD data sheet B9!

**Lightweight version with  
50 mm vision panel  
( $\Delta P \leq 3$  bar)**

### Operating conditions:

Temperature: (depending on glass and gasket)	100 °C 243 °C
Pressure:	$\leq 3$ Bar

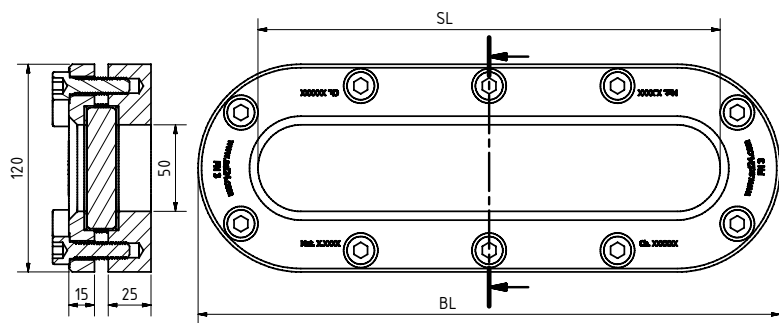

### Materials:

Flange:	1.4571, 1.4404, P265GH
Glass:	Borosilicate glass similar to DIN 7081
Gasket:	PTFE; FKM; NBR; C4400; Silicone; EPDM; Graphite
Screws:	A4-70
Special materials on request	

BL	SL	Kg	Tightening torque <sup>1</sup> (Nm)
270	200	6,5	13 ... 34 <sup>1</sup>
340	270	8,1	13 ... 34 <sup>1</sup>
410	340	9,8	13 ... 34 <sup>1</sup>
480	410	11,4	13 ... 34 <sup>1</sup>
550	480	13,0	13 ... 34 <sup>1</sup>
620	550	14,6	13 ... 34 <sup>1</sup>
690	620	16,3	13 ... 34 <sup>1</sup>
760	690	18,0	13 ... 34 <sup>1</sup>

<sup>1</sup> graphite gasket

## PRODUCTCODE:

Group	TYPE	ovr. length	Base frame*	Glass	Gasket	Variant
11	335	270 340 410 480 550 620 690 760	1: P265GH 2: <b>1.4571</b> 3: 1.4404 4: S355... <sup>3</sup> 7: 1.4462 8: Special	1: <b>Borosilicate glass (Boro)</b> <b>transparent similar to DIN 7081</b> 6: Special	1: PTFE 2: FKM 3: NBR 4: <b>C4400</b> 5: Silicone 6: EPDM 7: Graphite 8: Special	Assigned by ACI if required

**INFO:** Unless otherwise stated, the factory standard highlighted is supplied.

\*Cover frame according to quotation / order confirmation. <sup>3</sup> Material certificate 3.1 possible, without AD2000 W1

## SPECIAL DESIGNS/OPTIONS:

- a) High temperature version on request
- b) LED or halogen lights, ATEX-certified, EX
- c) Other options on request

## EXAMPLE:

**11-335-480-2-1-7-000 equals the product code:**

ACI Type 335  
480 mm long  
Base frame 1.4571  
Borosilicate glass  
gasket graphite  
standard version

## RECOMMENDATION:

For aggressive media or steam, mica discs should be used to protect the glass.