



Sight Glass Wiper

Option

With flexible Drive, full operating pressure

SWII

Application:

For manually activated cleaning, when required, of inside face of glass in sight ports. Particularly suitable for pressure and vacuum, vessels requiring test certification both in explosion hazardous as well as non hazardous operating areas.

The glass discs fitted into the assemblies correspond to DIN 7080 or DIN 8902 standards.

Suitable for circular sight glass assemblies nominal size DN 100 ... DN 200.

Operating Conditions:

Vacuum tight; pressure tight to 16 bar. Max. permissible temperature: 220°C (depending, however, on type of glass disc used).

Mounting:

By means of pressure tight glands through both base and cover flange of sight glass assembly; suitable for sight glass discs corresponding to DIN 7080 or DIN 8902.

Possible Combinations:

Simultaneous fittings of Lighting, flame proof or standard design, is possible with the wiper SW II BW, as is the fitting of a spray device.

Certification/Testing:

Test certificates issued by the state material testing authority Nordrhein Westfalen, Dortmund, are available.

Assembly/Materials

Pos.	Part
1.	Locking circlip 1.4568
2.	Washer A2
3.	Actuating knob (brass insert)
4.	Ratchet drive lever arm 1.4305
5.	Spacer ring 1.4305
6.	Locknut A4
7.	Threaded bush 1.4301
8.	Packing ring PTFE
9.	Tube securing bush 1.4571
10.	Compression nut 1.4571
11.	Flexible drive shaft 1.4310 or 1.4401
12.	Ratchet drive unit steel
13.	Drive boss 1.4305
14.	Shaft drive shank 1.4305
15.	Washer galvanized steel
16.	Compression taper ring 1.4571
17.	Wiper blade holder 1.4571
18.	Wiper blade silicone or PTFE
19.	Roll pin 1.4571
20.	Wiper arm axle 1.4571 or 1.4401
21.	Coil spring 1.4310
22.	Wiper carrier shroud 1.4571 or 1.4401
23.	Guide spigot 1.4571 or 1.4401
24.	Compression taper ring 1.4571
25.	Compression nut 1.4571
26.	Guide tube 1.4571

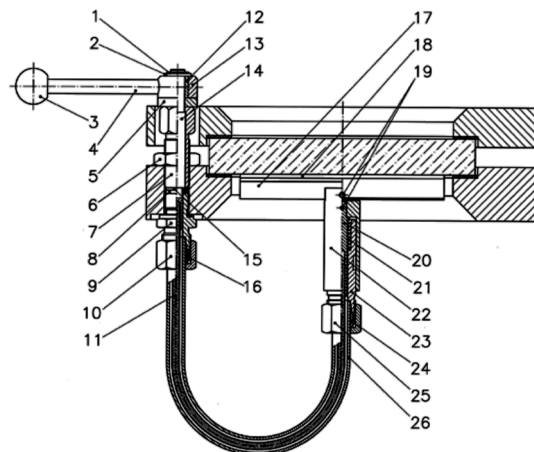

Assembly and Installation Instructions:

The wiper is actuated by a flexible shaft which engages at one end in the wiper blade holder and at the other in a lever operated ratchet drive mechanism which ensures drive shaft is always rotated in same direction.

A separate set of detailed installation instructions is included in the delivery.

Should you order a complete sight glass assembly with the wiper SW II BW, the additional machining of the base will be carried out by ACI.

Technical changes and errors reserved!

ACI Industriearmaturen GmbH
www.aci24.com • info@aci24.com
Version 2017-07-15



Sight Glass Wiper

Option

With flexible Drive, full operating pressure

SWII

Dimensions for sight glass wiper SW II BW

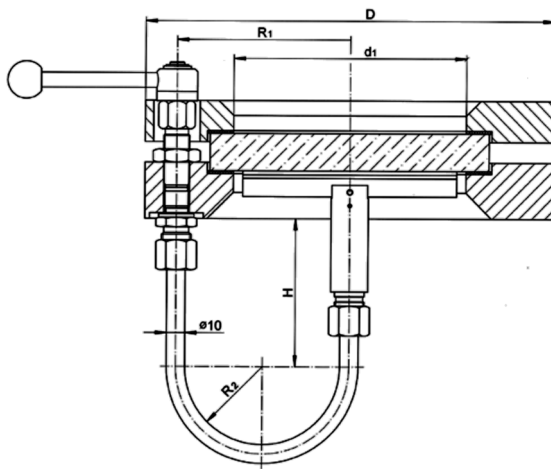

Size		1	2	3	4
Nominal size	DN	100	125	150	200
viewport	d ₁	125	150	175	225
flange	D	220	250	285	340
Wiper	R1	93	105	120	147,5
	R2	41,5	47,5	55	68,75
	H	79	69,5	85	63,5

Order data

Sight Glass Wiper SW II BW

Size [3]

Wiper blade [silicone-Kautschuk]

If ordering with complete assembly please give the following additional information:

- Sight glass assembly (DN/PN), materials
- Type and size of sight glass disc (borosilicate/sodalime)

Technical changes and errors reserved!

ACI Industriearmaturen GmbH
www.aci24.com • info@aci24.com
Version 2017-07-15