



Small gate valve

flange connection PN40

**A-KLS
340**

Design:

flange connection according to DIN EN 1092
compact size
external, rising stem
special design available
(welding connection, ASME, GOST, ...)

stem seal	gland seal
wedge	rigid wedge
operation	manual wheel
operating temperature	-10°C ... +400°C
operating pressure	max 40 bar (temperature dependent)
flange connection	DIN EN 1092-1 Form B1 PN40 alternative connections on request



example image

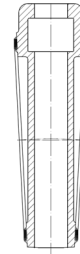

Detail: rigid wedge

Materials:

body	P250GH
stem	1.4021 / X20Cr13
seal	1.4021 / X20Cr13
stem seal	graphite
bonnet gasket	graphite / stainless steel

Dimensions:

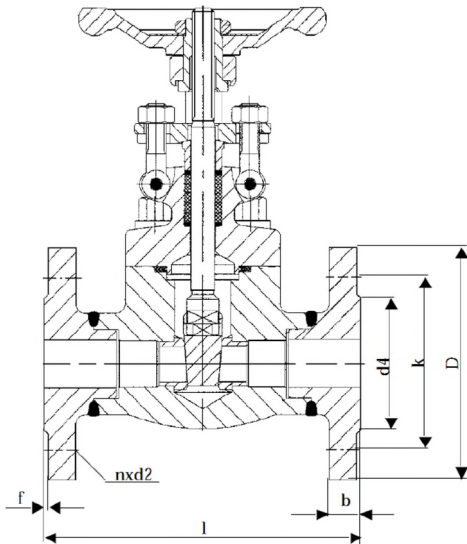

DN	D	k	b	n-ød	L
15	95	65	16	4-14	130
20	105	75	18	4-14	150
25	115	85	18	4-14	160
32	140	100	18	4-18	180
40	150	110	18	4-18	200
50	165	125	20	4-18	230

Technical changes and errors reserved!

ACI Industriearmaturen GmbH
www.aci24.com • info@aci24.com
Version 2018-06-29