

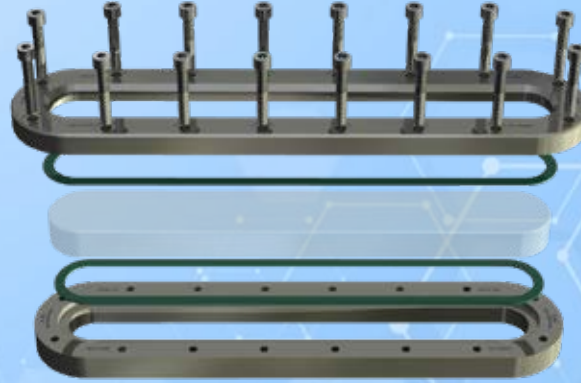

Rectangular sight glass PN 16

for welding in or on, wide visibility

Type 338



APPLICATION:

Observation and illumination of the liquid level inside closed vessels (boilers, tanks, silos, etc.).

These sightglasses are angular flange sockets for welding in or on, each completed with a firmly screwed sightglass plate inserted between the seals.

INSTALLATION NOTE:

After the base frame has been welded in, check whether the sealing surfaces have warped! If necessary, rework must be performed! Please also observe the specified torques for the screw connection! The operating pressure does not apply to the base frame, which must be checked together with the pressure device according to AD data sheet B9!

Oval version with
50 mm viewing panel
($\Delta P \leq 16$ bar)

Operating conditions:

Temperature: (depending on glass and gasket)	100 °C 243 °C
Pressure:	≤16 Bar

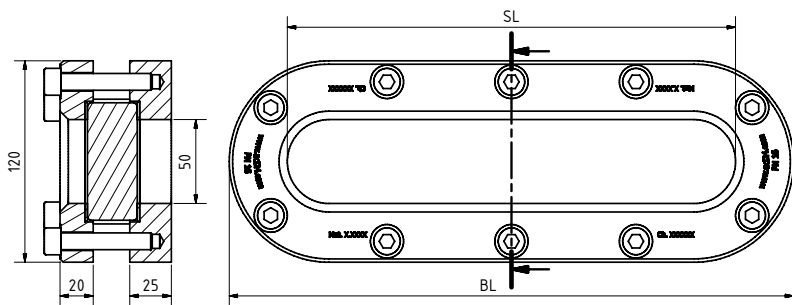

Materials:

Flange:	1.4571, 1.4404, P265GH
Glass:	Borosilicate glass similar to DIN 7081
Gasket:	PTFE; FKM; NBR; C4400; Silicone; EPDM; Graphite
Screws:	A4-70
Special materials on request	

BL	SL	Kg	Tightening torque ¹ (Nm)
270	200	7,5	15 ... 33 ¹
340	270	9,1	15 ... 33 ¹
410	340	10,8	15 ... 33 ¹
480	410	12,4	15 ... 33 ¹
550	480	14,0	15 ... 33 ¹
620	550	15,6	15 ... 33 ¹

¹ graphite gasket



Rectangular sight glass PN 16

for welding in or on, wide visibility

Type 338

PRODUCTCODE:

Group	TYPE	ovr. length	Base frame*	Glass	Gasket	Variant
11	338	270 340 410 480 550 620	1: P265GH 2: 1.4571 3: 1.4404 4: S355... ³ 7: 1.4462 8: Special	1: Borosilicate glass (Boro) similar to DIN 7081 6: Special	1: PTFE 2: FKM 3: NBR 4: C4400 5: Silicone 6: EPDM 7: Graphite 8: Special	Assigned by ACI if required

INFO: Unless otherwise stated, the factory standard highlighted is supplied.

*Cover frame according to quotation / order confirmation. ³ Material certificate 3.1 possible, without AD2000 W1

SPECIAL DESIGNS/OPTIONS:

- a) High temperature version on request
- b) Other options on request

EXAMPLE:

11-338-480-2-1-7-000 equals the product code:

ACI Type 338
480 mm long
Base frame 1.4571
Borosilicate glass
gasket graphite
standard version

RECOMMENDATION:

For aggressive media or steam, mica discs should be used to protect the glass.